

2020-2021 CORPORATE PROFILE



Group Companies are-----

- ❑ Home Sense Interior Solution
- ❑ Home Sense Steel & Building Construction
- ❑ SAIFAN Furniture & Door
- ❑ Home Sense Builder

Corporate Office Address:

House # 433 Road # 30, Mohakhali DOHS,
Dhaka-1212, Bangladesh

Cell : 01841418080

Whatsapp : 01739370416

Email : info@homesensebd.com



WE ARE THE BEST TO BUILD YOUR DREAM

www.homesensebd.com

Basic Information

Group Of Company's

Company Name

Home Sense Interior Solution

Company Logo



Company Name

Saifan Furniture & Door

Company Logo



Company Name

Home Sense Steel & Building Construction

Company Logo



Company Name

Home Sense Builder

Company Logo



Home Sense BD Product and Service

Our field of expertise is turnkey basis

- R.C.C Building Construction,
- Steel Building Construction,
- Glass Works and Fabrication,
- Interior, exterior with Furniture and
- Building Materials

Corporate Office Address:

House 433 Road 30, Mohakhali DOHS, Dhaka-1212,
Bangladesh

Factory Address:

Nasirabad Trimohono Gudara Gath, Khilgoan, Dhaka

Website : www.homesensebd.com

Contract
Person-1

M. Mainul Islam

(Managing Director)

Cell : 01818829897

Whatsapp: 01739370416

Email: mainul@homesensebd.com
mainul.a79@gmail.com

Contract
Person- 2

Md. K S Zaman Jewel

(Chairman)

Cell : 018 4141 8080

Whatsapp: 018 4141 8081

Email:

safarouzaman@homesensebd.com
safarouzaman@gmail.com

Management



Md. Khandaker S. Zaman Jewel
Chairman



M. Mainul Islam
Managing Director



Engr. M Sultan Mahmud
Director & CEO



Mr. Joy Bhoumick
Director & Head of Seals (Chittagong)

About Us

Home Sense BD Group Ltd is a leading Bangladesh based Architectural, Civil Engineering & Building Contractor, Interior & Furniture, Building Material, Government and Corporate Goods supplier and contractor. Our head office is in Dhaka Mohakhali DOHS located in the Bangladesh to serve our clients nationwide. Formed in 2011, we are Achilles approved and carry out full Interior & Furniture, civil engineering and building works packages including ground works, drainage and concrete packages across the all over Bangladesh.

We work for a select group of clients, which comprise a mix acting as the Principle Contractor as well as working for a few main contractors.

Why Home Sense BD ?

We have perfect blend of knowledge and talents that comprises of specialist engineers, architects, interior designers and resource study consultants. These unique teams help us understand and provide solutions for any personalized requirements of our clients.

Mission

To provide quality workmanship and customer service and maintain the highest level of professionalism, honesty and fairness in our relationships with our customers, employees and vendors. To grow by continually providing useful and significant products, services, and solutions to markets we already serve – and to expand into new areas that build on our competencies and customer interests.

Vision

To be the builder of choice for value minded clients and high performing employees and To earn the trust and respect of our customers in Bangladesh and abroad.

Our Core Values

Excellence: We strive for excellence in quality, and we continuously innovate, utilizing advanced technologies.

Teamwork: We insist on mutual respect, cooperation and mutual encouragement to achieve each individual's potential.

Integrity: We act with reliability, honesty and fairness.

Commitment: We are fully dedicated to delivering our objectives through the most efficient use of resources

Sustainability: We are committed to safeguarding all stakeholders, including especially the health and safety of our employees, society as a whole and the environment.

Accountability: We are fully accountable for carrying out our responsibilities in accordance to the values and principles of HSBD.

INTEGRITY. EXPERTISE. LEADERSHIP.

Our expertise in estimating, construction, project management and preconstruction services ensures that our customers receive a quality product at a fair price and in a reasonable time frame. This is accomplished through the selective use of responsible subcontractors, hiring and retaining first class employees, and working for clients that share a belief in open, honest, and direct communication.

Regardless of whether you are an owner, architect, designer, engineer, tenant, broker, subcontractor, or supplier, you are a respected member of our team and will be treated as such. This commitment to team and to open project leadership yields not only successful construction projects, but more importantly, satisfied customers. The end result of this style of relationship building is 100% referable customers.

We're committed to your success. Contact us today and let us know how we can help your next project succeed.

Our People

Our clients know that what make their projects run smoothly is the professionalism, skill and experience of the people who work on them. The right people care about the work they do, are active in helping the client overcome challenges and are an asset on the project.

Whilst skills can be taught the all-important professionalism and maturity cannot. We decided years ago that to be a high-quality civil engineering and construction firm, HSBD would need to recruit on the things that cannot be taught so that both ourselves and our clients know that only the best people are going to turn up on site. We carry around 60+ of our own skilled tradesmen, technical and support teams, which supports us delivering high quality schemes at the best value. We supplement this with our loyal and long standing supply chain to suit each contract.

The same logic is applied to our supply chain – our relationships with them are long-standing and are based on an understanding of what we expect of them. And it works: we notice the difference – and you will too.

Services

HSBD provides services to a number of sectors including the education, commercial/industrial, government, utilities/infrastructure, leisure, energy and renewable energy sectors.

We have successfully completed construction projects across the Bangladesh within diverse and complex environments, for the public and private sector.

We are extremely dedicated to the projects we work on and seek to offer the most comprehensive and efficient delivery possible.

We have an enviable reputation of providing safe and responsible building and civil engineering services, achieving project completion within budget and to the highest standards of quality.

Our Ethics

Home Sense BD Group Ltd adhere to company policies that are designed to ensure that we operate our business to meet or exceed the requirements of our customers, meets all legal requirements, and upholds Environmental and Health & Safety measures.

Those policies include:

- > Equal Opportunities Policy
- > Anti-Bribery Policy
- > Harassment and Bullying Policy
- > Health & Safety Policy
- > Quality Policy
- > Environmental Policy
- > Performance Development Review Policy
- > Drugs and Alcohol Policy

Teamwork:

- > Group team work & Initiative
- > Safety & Awareness
- > Quality
- > Customer Focus
- > Selected Time Handover

Fundamental to Home Sense BD Group are the core values we believe in and practice. Identified during the Investors in People Assessment they underpin all aspects of our business. Our Values offer clear business benefits and their link with the Performance Development Review Process help our employees understand what is expected from them.

Our Valuable Client



চট্টগ্রাম ডায়াবেটিক জেনারেল হাসপাতাল



Advancing Knowledge Enriching Lives



Home Sense Interior Solution

Home Sense Interior Solution offering you Best quality Manufacture and Supply all kinds of Home, Residential hotel ,restaurant , Educational, office furniture, Interior and Exterior Design and Decoration work of your home, apartments, office, showroom, hotel , restaurant, coffee shop and institute Steel Structure Design and all kinds of office and residence furniture at affordable price. We help to make your space creative look. Our Mission is to develop exceptional design idea and Solution for our clients through the Creative building of human needs, value creation art and Science. We do all kinds of Interior and Exterior design, Import, supply materials and Decoration for your project.

About our Interior Work

Workplace Consultancy

At the heart of every organization are its culture, workplace practices, and most importantly it's people. Workplace consultancy aims to understand, translate and respond to all elements of a business. Through analyzing the impact of space on your people, technology and business processes we develop a full Understanding of the objectives behind your relocation and refurbishment. This information becomes the blueprint for creating intelligent, hardworking solutions to address your business's ongoing needs.

Space Planning and Interior Design

Our experienced in-house team of designers is dedicated to providing insightful interior solutions for the commercial workplace. Their creative approach, balanced with an acute commercial awareness enables them to create functional working environments that enhance and promote your business's objectives and its culture. We place high value on progressive working approaches, continually striving to bring innovative ideas into our designs, finding optimum working solutions for all our clients.

Interior Fit-Out and Refurbishment.

Our experienced team is committed to delivering projects of consistent, high quality; a commitment that our clients have come to rely upon. We work closely with your team to ensure that your aspirations and objectives can be delivered within the constraints of the building, overall budget and time expectations. This ensures a smooth transition from concept to completion.

Project Management.

We have developed a project management approach that focuses on minimizing the effect of a relocation or refurbishment on day-to-day business practices, enabling your team to focus on their core business activities. Our project managers are involved throughout every project ensuring successful execution and delivery within the agreed time scale and budget. This guarantees that the project is delivered to meet, and often exceed your expectations

Why You Choose us?

- > We are a Manufacture and Supplier of all kinds of Furniture
- > We have creative Experience and professional Engineer, Architect, Designer, fine Carpenters, Paint worker and Other stuff for Interior.
- > Our have won Skilled Workers in our Factory.
- > We care for your bud get.
- > Fast Client Service and Commitment date handover project to client.
- > We are adapted to most modern design.
- > Fine finishing and Outlook.
- > Our service is all over of Bangladesh.

Number of Outlets: Dhaka City, and Chittagong City in Bangladesh.

Import Markets: Malaysia, China etc.

Our Service and Product categories

Interior Decoration Service categories

- >Architecture, Master Planning Project Management, Sustainable Design, Space Planning for Interior-Exterior Design.
- >All kinds of Renovation and Decoration Work.
- > 2D, 3D Animation modeling interior-Exterior view and Design Consultancy.
- > Best latest design kitchen cabinet, kitchen hood Solution.
- > Latest Modern false ceiling work (a) Gypsum ceiling b) Metal ceiling (c) Plastic board ceiling
- > Decorative wooden/flayer ceiling e) Drop and Gypsum Design ceiling.
- > All kinds of Signboard Work. Neon, LED etc.
- > Wall Cabinets/Certain Wall.
- > Wooden floor/ vinyl flooring/Tiles Work.
- > Top garden Design and Implementation.
- > We Steel Structure Design.
- > Decorative Wall paint/ Painting, Polish and Lakers Work.

Security System and Others Service categories

- > All kinds of electrical design and lighting Works. CCTV surveillance System, Door Punch Control System. Attendance Control System
- > All kinds of Aluminums Sliding and Fixed partition.
- > 10mm fixed Glass partition, Decorative glass, Tempered Glass door supply and Installation.
- > Spider glass partition, Automatic Door supply and Installation.
- > Low/Full height fabric and wooden partition.

Our Interior Project

Clint: Abu Monsur Ripon
Interior Project Uttara Resident
House 44, Road4 , sector 3, NHS NASA Tower 8th floor



Clint: Square Group
Interior Project Corporate office
Gulshan-2 , Dhaka

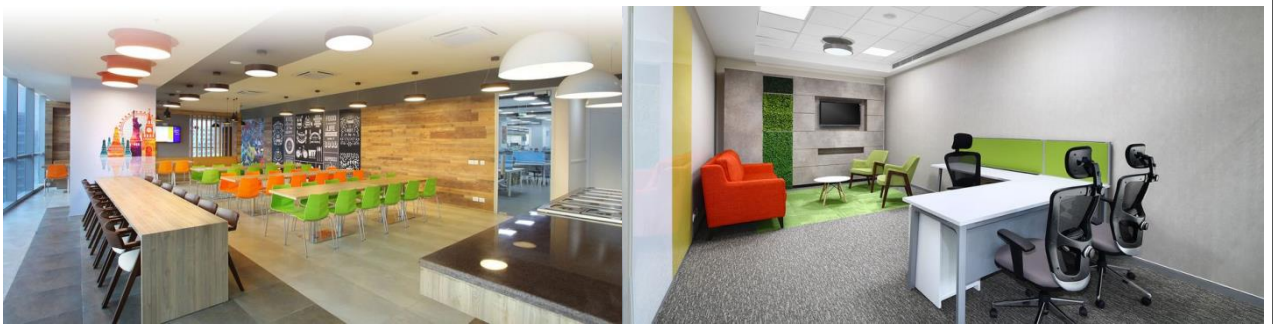

Clint: Mr. Kamrul Interior Project Restaurant
Chittagong

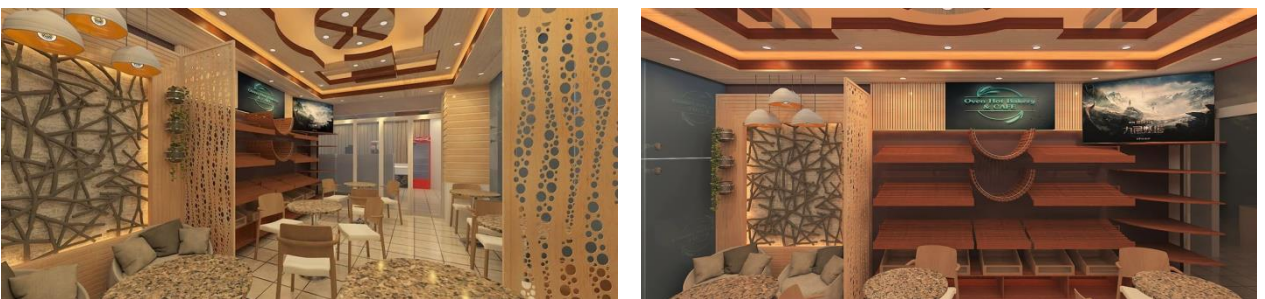

Our Interior Project

Clint: VFL Group
Interior Project Corporate office
Gazipur,



Clint: Sonic Prime Group
Interior Project Corporate office
Mirpur DOHS, Dhaka



Clint: Mr. Akkas Ali
Interior Project Residential
Gulshan-1, Dhaka





Home Sense Steel & Building Construction

About Us

Home Sense Steel & Building Construction is professional manufacturer and engineering company for space frames, steel structures, curtain walls, and membrane structures project with full capability of research, design, fabrication, construction, supervision service. We have equipped with advanced software and system, and we have professional designers and technical engineers. Our steel structure plant covers an area of more than 100,000 square meters. The plant is equipped with developed produce facilities. Our Annual production capacity: 36000 tons We are involved with portal steel structures, steel space frames, curtain walls, roofs and membrane structures.

Your Metal Building Solution

Home Sense Steel Building Solution's vision is to build happiness. Happiness for our customers, employees and suppliers. We provide attractive, high quality, cost-effective construction solutions that we deliver in safe and healthy working environments. We specialize in difficult challenges that require creativity, problem-solving and extensive experience.

The Industries We Serve:

- Industrial – Mining, Forestry, Hydro, Oil & Gas, Aviation, Marine, Waste Water Treatment, Manufacturing
- Commercial – Retail, Warehousing, Office Space, Storage Facilities
- Community – Sports Centers/Arenas, Schools, Churches, High rise Building
- Residential- Steel Structure residential house, duplex house, light house , prefab house , container house

Our Vision

BUILDING HAPPINESS

Our company vision is "Building Happiness," and this is something that we strive to do in every interaction we have with our teammates, our customers, our suppliers, and our community. One of our defining core values is Doing the Right Thing, no matter what it costs us. We believe in working hard, but also maintaining a healthy balance in our lives and our families.

Our Mission

Building a better world through collaboration, competence and car

We also provides the following services- Steel Structure Works

1. Industrial Building
2. Steel Warehouse
3. Textile Industry
4. Garment Factory
5. Multi storied Steel Building
6. FEED MILL & AUTO RICE MILL STRUCTURE
7. Poultry Shed
8. Roof Top Steel Shed
9. Steel Re-rolling Mill
10. Cement Factory
11. CNG Filling Station
12. Single or Multistoried Aircraft Steel Hanger
13. Steel Tower Building
14. Show Room
15. Industrial Steel Racking
16. External Steel Lift Core
17. Steel Resort/Dormitory Building
18. Hospital
19. University building.
20. Agro Farm Steel Shed

We also provides the following services- RCC & Steel House Works

1. Duplex And Simplex House
1. Steel and RCC combined Residential house
2. Light House
3. Prefab House
4. Steel & RCC combined High Rise Building
5. Ware house Storage Rack

Steel structure Project

Steel structure project @ Banani
Office cum show room.



Steel structure project @ Gazipur



Steel structure project @ Dhaksinkhan



Steel structure project @ Sripur

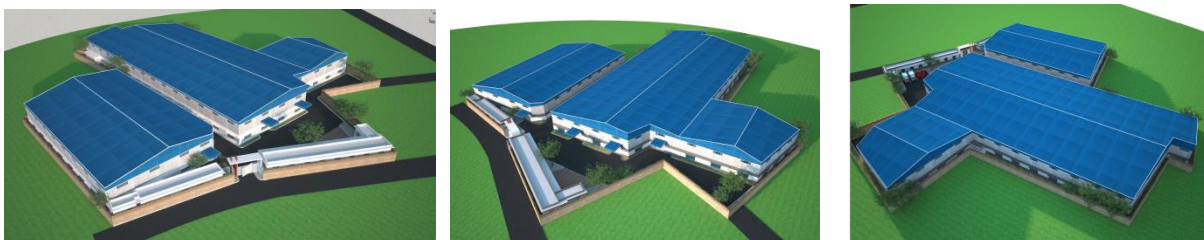

Residential House Project

Clint : KDS Group ,Residential Banglo House , Phothiya ,Chittagong



Clint : Mr. Rony talukdar, Residential House , Rajbari



Clint : Mr. Dhiran Chakma, Residential House , Rangamati



Clint : Mrs. Salina hayat, Residential House , Rangpur



Steel Structure Factory

Our Steel Structure Manufacture factory Equipment

Manufacturing Partner: NDE Steel Structures Ltd

Address: Paragaon (Borochala), 2240, Bhaluka and Gazipur

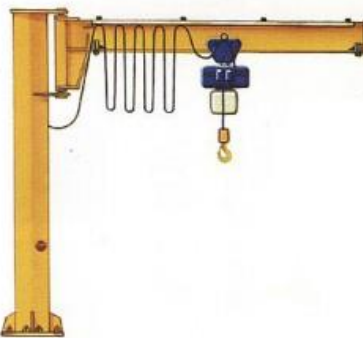



Quality Assurance/Quality Control

We stand strongly on quality is the hall mark of Home Sense Steel & Building Construction . Since the inception of HSSB there has been a continuous effort to pursue the highest quality in the Pre engineered steel building industry. Our effort materialized in the award of Leed certification from INNOWELL

A separate Quality Department with functions under the top management at the factory is dedicated to undertake quality check at every level of stages from entry to delivery to site. This quality check is carried out throughout the period of fabrication until completion of delivery thus ensuring that only those material that qualify the stringent quality tests of HSSB Quality Department are delivered to the client. This ensures a product of the finest quality and the difference is evident when compared .QA&QC department is strictly maintain the ITP,WPS sated by client or HSSB standard.

We use of Prime Quality product and no product from Ship Breaking Material or Non Standard Product that is not in accordance with the latest international code is used by HSSB . All materials are imported from a variety of countries that includes Australia, Japan, China, India, Korea, Vietnam, etc. The imported plates are subjected to quality test before fabrication under the supervision of the QA&QC Department of HSSB at the Factory end.

Similarly every item needed for the valuable client is imported from time tested suppliers of world class material be it Bolts, Self Drilling Screws, Insulation, Sky Lights or even the Welding Consumables. In fact every accessory that goes with the building is selected so as to endure the test of time and ensure that the HSSB Quality stands out in every aspect.



Saifan Furniture & Door

Saifan Furniture is an office and home furniture whole seller supplier, online furniture/home decor retailer. We began as a regular Brick and Mortar furniture store located in Bangladesh offering our customers brand name furniture at affordable prices. Our retail locations are proudly serving residents of Bangladesh.

Home and Office Furniture by Design website is aimed to provide you with the latest in home furnishings, home decor and accessories at a price you can afford. We always carry products that will be the focus of your home's décor with superior selection, value, and quality.

CUSTOMER SATISFACTION

Here at saifanfurniture.com we know how difficult it can be when purchasing online, that's why our company gives maximum priority to customer satisfaction. Our highly trained staff is ready to assist you with any questions regarding your purchases. You can be assured that our customers are our main concern when it comes to consumer happiness. When you shop at saifanfurniture.com you can shop with great confidence that YOU the customer will always be treated with the utmost care and respect. Our goal is to provide you with a wonderful experience and keep you coming back for your future furniture purchases.

Our Service and Product categories

Furniture Product categories

- All Kinds of Residence furniture manufacturing and supplier
- All Kinds of office furniture manufacturing and supplier
- Residential Hotel Furniture
- Hospital Furniture
- Educational furniture
- Restaurant and Cafe furniture.
- Super Shop Furniture.
- All kinds of Tender Furniture
- All Kinds of Door and Door frame
- Work Station
- Stainless Steel / Mild Steel Office Almira, file Cabinet, Locker Etc
- convention hall furniture

Capacity of Furniture machinery & equipment

Saifan Furniture's cutting edge selection of dedicated machinery forms a complete solution to almost any interior and office furniture need. A summary is provided below of machinery utilized in each of the production line's departments.

Timber and Board works:

1 x Altdorf 3Ph panel saw	These four machines are employed to effectively size solid, particle and MDF timber boards.
1 x Austro PS 3200 3Ph panel saw	
2 x small extractor fans	These machines ensure the precise and consistent machining of solid, particle and MDF timber boards.
1 x Robinson 3Ph spindle	
1 x small spindle	
1 x SCM 2200 combination planer/thickener	
1 x standard rip saw	Once the timber has been cut and machining is completed, the machines listed above see to the finishing of solid, particle and MDF timber boards.
1 x LASM LBK 150 edge sander with electric board feeder	
1 x Meber LEM 3000 stroke sander	
1 x Master wood K21 multi borer	
1 x Tool mate drill press	
1 x Sagar band saw	
1 x CFW 3 bag dust extraction unit	
1 x CFW 4 bag dust extraction unit	

Steelworks:

2 x Thomas 50 steel cut-off saw Each of these machines plays a vital	Each of these machines plays a vital role in the precision cutting, drilling, bending, welding and cleaning of all school and office furniture, chairs, tables and various components
role in the precision cutting, drilling	
bending, welding and cleaning of all	
school and office furniture, chairs,	
Tables and various components	
1x Makita steel cut-off saw	
2x Pedrazzoli hydraulic pipe-bender	

Finishing works:

2x Pedrazzoli hydraulic pipe-bender	The Tech 80 boring and routing Center is numerically controlled and designed for the most specialized machining requirements, allowing for a zero factor of human error.
1 x SCM Olympic K201 edge bander with dust extraction	This edge bander allows the machinist to apply solid timber, Melamine and plastic edges to the finished boarding.

QUALITY POLICY

Saifan Furniture & Home Sense Interior Solution is committed to a policy of total quality management that guarantees all products and services meet the highest standards.

Saifan Furniture brings values and benefits to the customers and ensures best customer satisfaction.

Quality control processes

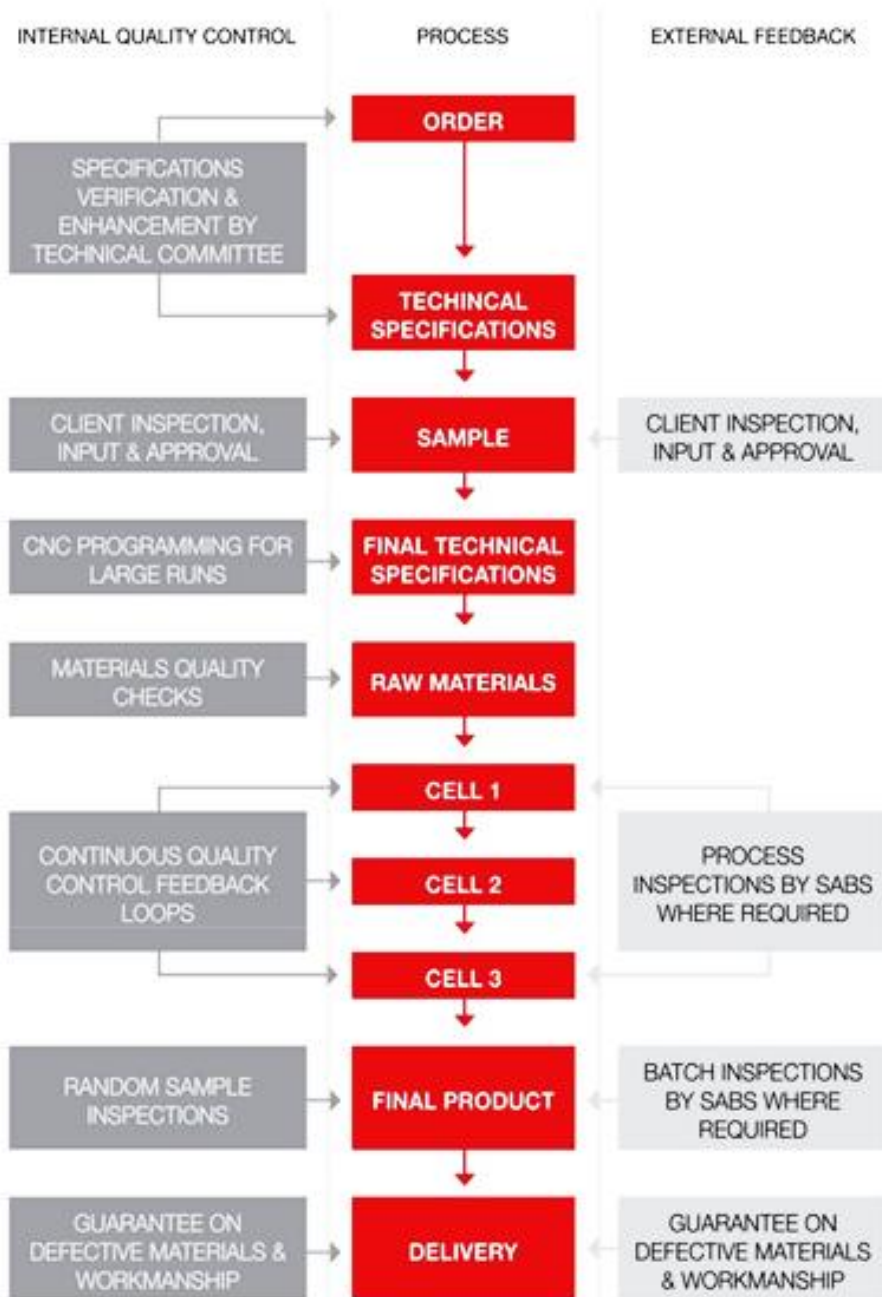

Furniture Factory & Showroom

Furniture & Interior Factory

Factory address:

Nasirabad, Trimohoni Gudara Ghat, Khilgoan, Dhaka

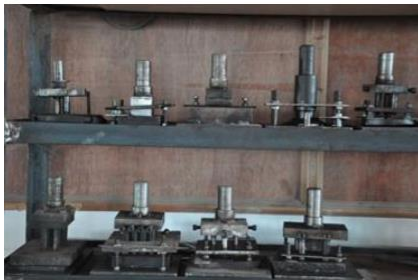

Showroom

Showroom address:

220/4-A , South Pirarbag Amtola, Mirpur, Dhaka-1205



Home Sense Builder

Home Sense Builder, Inc. is a Real Estate & Development company that has been serving the community since 2016. Over the years, we have helped many people realize the dream of building a home. At Future We Planning Start Big Development Project.

When you have a home built, you are not only buying a product, but also a service. As an experienced custom home builder, we have the ability to control the quality of our workmanship to the highest standards. We employ only qualified personnel who are committed to upholding this high level of excellence. We strive to give the best possible service before, during, and after the construction process.

We design each home to meet the individual needs of each client. The construction process is scheduled well in advance and closely monitored to ensure that it goes smoothly and on time. We help you enjoy the process of selecting all of the items within your house to give it your personal touch. We are committed to responding quickly to address any questions that you might have. The four main cornerstones of our business are integrity, quality, service, and value.

Integrity

To conduct business with complete integrity in all facets.

Quality

To provide the highest level of quality materials, service and workmanship in all areas of every project.

Service

To provide superior service by:

- >> Promptly returning all phone calls and responding to all emails
- >> Establishing and meeting strict construction schedules
- >> Making each client feel like they are the only client
- >> Treating each client with respect and professionalism
- >> Listening intently to each client's needs and desires

Company Trade License



ঢাকা উত্তর সিটি কর্পোরেশন, ঢাকা
রাজপথ বিভাগ (অফিস-৩)
তলশান- ২, ঢাকা।
ফোন :- ৯৮৯৩৫২১



লাইসেন্স ইস্যুর বিবরণ

ওয়ার্ড নম্বর	ইস্যুর ক্রমিক নম্বর	ইস্যুর তারিখ
২৫	৩০২৬	২৯/০১/১৬



ট্রেড লাইসেন্স
(TRADE LICENCE)

No: 03-054416

স্থানীয় সরকার (সিটি কর্পোরেশন) আইন ২০০৯-এর ধারা ৮৪-এর প্রণয় ক্ষমতাবলে সরকার প্রণীত আদর্শ কর তফসিল ২০০২ এর ৬ নং অনুচ্ছেদ অনুযায়ী পেশা, ব্যবসা-বাণিজ্য এবং জীবিকানুষ্টি উপর আরোপিত কর আদায়ের লক্ষ্যে নিম্ন বর্ণিত ব্যক্তি/প্রতিষ্ঠানের অনুকূলে এ ট্রেড লাইসেন্স ইস্যু করা হলো। যার কার্যকরিতার মেয়াদ ৪ এবং ৫ পৃষ্ঠায় উল্লিখিত সময় পর্যন্ত বলবৎ থাকবে।

১. মালিকের নাম : মোঃ খন্দকার সাফাফুজ্জামান
 ২. পিতা/পামীর নাম : হুজু মোঃ খন্দকার কুদ্দুস ডিয়া
 ৩. মাতার নাম : মোছাঃ খন্দকার দেলোয়ারা বেগম
 ৪. মালিকের ঠিকানা :
বর্তমান বসবাসের ঠিকানা : হুজী/ রেজিস্টার্ড ঠিকানা
হোমিং নং : ২২৫/ সি পূর্ব নাথান পল্লী হোমিং নং/ গ্রাম : ৫
রোড নং : রোড নং / পোস্ট অফিস :
থানা : ০৩গাঁও থানা :
ঢাকা ১২৫ (পোস্ট কোড) ডেপু
 ৫. ব্যবসা প্রতিষ্ঠানের নাম : হোম সেন্ট্র ইন্টিগ্রেটেড এন্ডিক্সন
 ৬. পরিশোধিত মূলধন (সিঃ কোম্পানীর ক্ষেত্রে) : টাকা
 ৭. ব্যবসা প্রতিষ্ঠানের ঠিকানা : ২২৫/ সি পূর্ব নাথান পল্লী ০৩গাঁও ঢাকা-১০৫
ফোন ও ই-মেইল (যদি থাকে) :
৮. স্বাক্ষর খরচ : প্রবর্তনাকৃত
 ৯. আদর্শ কর তফসিল ২০০২ এর ক্রমিক নং : ৪৬)
 ১০. ট্রেড লাইসেন্স/ নবায়ন ফি (বার্ষিক) : টাকা (অকে) ২০০০/- দুই হাজার
(কথায়) : টাকা :
১১. সাইনবোর্ড কর (বার্ষিক) : টাকা (অকে) ৪৫০/- চারশত কতক
(কথায়) : টাকা :
১২. ইস্যুকৃত চালান : বই নম্বর ০৬০৫৪৪১৬
- লাইসেন্সধারীর নিকট হতে সকল বকেয়া পাওনা বিবিধ বশিদ নম্বর ^, তাহ - এর মাধ্যমে আদায় করা হয়েছে।
(লাইসেন্সটি ২৭/৪ নম্বর ডি.সি.আর. নইয়ের ৭৫ পৃষ্ঠায় লিপিবদ্ধ করা হয়েছে।

লাইসেন্স ও বিজ্ঞাপন সূপারভাইজার
(নাম ও পদবীসহ সীল)
সিটি কর্পোরেশন
রাজপথ ও উত্তর সিটি কর্পোরেশন
তলশান-২ (অফিস-৩)
ঢাকা উত্তর সিটি কর্পোরেশন

সিটি কর্পোরেশন
অফিস-৩
(নাম ও পদবীসহ সীল)
সিটি কর্পোরেশন
রাজপথ ও উত্তর সিটি কর্পোরেশন
তলশান-২ (অফিস-৩)
ঢাকা উত্তর সিটি কর্পোরেশন

Company Trade License



ঢাকা উত্তর সিটি কর্পোরেশন, ঢাকা
রাজস্ব বিভাগ (অঞ্চল-৪)
মিরপুর, ঢাকা।
ফোন - ৯০০২৬৫২



লাইসেন্স ইস্যুর বিবরণ		
ওয়ার্ড নম্বর	ইস্যুর ক্রমিক নম্বর	ইস্যুর তারিখ
৩৪	৭২৮৮	৯/২ ২০২৭



ট্রেড লাইসেন্স
(TRADE LICENCE)

No: 04-33488



স্থানীয় সরকার (সিটি কর্পোরেশন) আইন ২০০৯-এর ধারা ৮৪-এর প্রদত্ত ক্ষমতাবলে সরকার প্রণীত আদর্শ কর তফসিল ২০০২ এর ৬ নং অনুচ্ছেদ অনুযায়ী পেশা, ব্যবসা-বাণিজ্য এবং জীবিকাবৃ্তির উপর আরোপিত কর আদায়ের লক্ষ্যে নিম্ন বর্ণিত ব্যক্তি/প্রতিষ্ঠানের অনুকূলে এ ট্রেড লাইসেন্স ইস্যু করা হলো। যার কার্যকরিতার মেয়াদ ৪ এবং ৫ পৃষ্ঠায় উল্লিখিত সময় পর্যন্ত বলবৎ থাকবে :

- ১। মালিকের নাম : মোঃ ছাদ্দাতুল্লাহ মাহমুদুল হক
- ২। পিতা/স্বামীর নাম : মোঃ ছাদ্দাতুল্লাহ কুদ্দুস মিল্লাহ
- ৩। মাতার নাম : ছাদ্দাতুল্লাহ দেলোয়ার বেগম
- ৪। মালিকের ঠিকানা :
বর্তমান বসবাসের ঠিকানা : স্থায়ী/রেজিস্টার্ড ঠিকানা ২২৫/মি পূর্ব নতুন মার্গ
হোল্ডিং নং : প্লট: ৩৩ (ডেমি ভেন্ট) ব্লক: অ হোল্ডিং নং/গ্রাম : ৩০৫১৯৩ জিএসআইজিএন
রোড নং : মেডেশন-৬ মেইন রোড-২ মিঃ পূঃ-২ রোড নং/পোস্ট অফিস :
থানা : মেনপাড়া চার্বত থানা : মেড-২২৫
ঢাকা ১২২৬ (পোস্ট কোড) জেলা :
৫। ব্যবসা প্রতিষ্ঠানের নাম : = ছাদ্দাতুল্লাহ মাহমুদুল হক ও ছাদ্দাতুল্লাহ বেগম
৬। পরিশোধিত মূলধন (লিঃ কোম্পানীর ক্ষেত্রে) : টাকা
৭। ব্যবসা প্রতিষ্ঠানের ঠিকানা : প্লট: ৩৩ (ডেমি ভেন্ট) ব্লক: অ মেডেশন-৬ মেইন রোড-২
ফোন ও ই-মেইল (যদি থাকে) : মেনপাড়া চার্বত মিঃ পূঃ-২ মেডেশন-২২
৮। ব্যবসার ধরণ : = অসম্পূর্ণ বিক্রয়
৯। আদর্শ কর তফসিল ২০০২ এর ক্রমিক নং ৬(৮), ৪৯(৬)
১০। ট্রেড লাইসেন্স/নবায়ন ফি (বার্ষিক) : টাকা (অংকে) ৪০০০/-
(কথায়) ৪ হাজার টাকা।
১১। সাইনবোর্ড কর (বার্ষিক) : টাকা (অংকে) ৪৮০/-
(কথায়) ৪৮০ টাকা।
১২। ইস্যুকৃত চালান : বই নম্বর ৩৩৪৮৮
লাইসেন্সধারীর নিকট হতে সকল বকেয়া পাওনা বিবিধ রশিদ নম্বর , তাং এর মাধ্যমে আদায় করা হয়েছে।
(লাইসেন্সটি) ৪ নম্বর ডি.সি.আর. বইয়ের ২৭২ পৃষ্ঠায় লিপিবদ্ধ করা হয়েছে।

লাইসেন্স ও বিজ্ঞাপন সুপারভাইজার
(নাম ও পদবীসহ সীল)

মোঃ আমির হোসেন খান
লাইসেন্স ও বিজ্ঞাপন সুপারভাইজার
রাজস্ব অঞ্চল-৪ (মিরপুর)
ঢাকা উত্তর সিটি কর্পোরেশন।

কর কর্মকর্তা
অঞ্চল-০৪
(নাম ও পদবীসহ সীল)

মোঃ ছাদ্দাতুল্লাহ হোসেন
কর কর্মকর্তা
রাজস্ব অঞ্চল-৪ (মিরপুর)
ঢাকা উত্তর সিটি কর্পোরেশন।

BIN Registration Certificate



Government of the People's Republic of Bangladesh
National Board of Revenue

Mushak-2.3

Customs, Excise and VAT Commissionerate, Dhaka (North)
Gulshan Division

Value Added Tax Registration Certificate

This is to certify that the person whose details are given below is registered under Value Added Tax and Supplementary Duty Act, 2012 (Act No. 47 of 2012)

BIN : 002834479-0101

Name of the Entity	: HOME SENSE INTERIOR SOLUTION
Trading Brand Name	: HOME SENSE INTERIOR SOLUTION
Old BIN	: 18111051192
e-TIN	: 117526897490
Address	: 225/c , East NakhhalPara ,Tejgoan I/A; Tejgaon I/A PS; Dhaka-1215; Bangladesh
Issue Date	: 23/03/2020
Effective Date	: 23/03/2020
Type of Ownership	: Proprietorship
Major Area of Economic Activity	: Services, Retail/Wholesale Trading, Supplay Goods



This is a system generated certificate and doesn't require any signature

BIN Registration Certificate



Government of the People's Republic of Bangladesh
National Board of Revenue



Mushak-2.3

Customs, Excise and VAT Commissionerate, Dhaka (West)

Value Added Tax Registration Certificate

This is to certify that the person whose details are given below is carrying on Taxable business and registered under Value Added Tax and Supplementary Duty Act, 2012 (Act No. 47 of 2012)

Business Identification Number (BIN) Details

BIN : 000173578

Name of the person : Saifan Furniture And Door
Registration : Registered for VAT
Registration Type : Branch
Date of Effect : 05/2017
Date of Issue : 24/05/2017



This is a system generated certificate and doesn't require any signature

TIN Registration Certificate



Government of the People's Republic of Bangladesh

National Board of Revenue

Taxpayer's Identification Number (TIN) Certificate

TIN : 117526897490

This is to Certify that MD. KHANDAKAR SAFAROU ZAMAN is a Registered Taxpayer of National Board of Revenue under the jurisdiction of Taxes Circle-301 , Taxes Zone 14, Dhaka.

Taxpayer's Particulars :

- 1) Name : MD. KHANDAKAR SAFAROU ZAMAN
- 2) Father's Name : Late Khandakar Kustu Mia
- 3) Mother's Name : Khandakar Delowara Begam
- 4.a) Current Address : Prop. of M/s. Home Sense Interior Solution, 225/C, East Nakhhalpara, Tejgaon I/A, Dhaka
- 4.b) Permanent Address : 225/C, East Nakhhalpara, Tejgaon I/A, Dhaka
- 5) Previous TIN : Not Applicable
- 6) Status : Individual

Date : May 26, 2016

Please Note:

1. A Taxpayer is liable to file the Return of Income under section 71 of the Income Tax Ordinance, 1986.
2. Failure to file Return of Income under section 71 is liable to-
 - (a) Penalty under section 124, and
 - (b) Prosecution under section 164 of the Income Tax Ordinance, 1986.



Deputy Commissioner of Taxes
Taxes Circle-301
Taxes Zone 14, Dhaka
Address : 101, Ai-Tarikh Tower, Bijoynagar, Dhaka Phone :

N. B. This is a system generated certificate and requires no manual signature.

TEX Clearance Certificate



GOVERNMENT OF THE PEOPLE'S REPUBLIC OF BANGLADESH
NATIONAL BOARD OF REVENUE
INCOME TAX WING

INCOME TAX CERTIFICATE

PARTICULARS OF THE TAX PAYER :

- a) Name : Md. Khandakar Safarou Zaman
b) Father Name/Husband's Name : Late- Khandakar Kustu Mia
c) Present Address/Registered Office : 225/C, East Nakhla Para, Tejgaon, Dhaka.
d) Permanent Address : ----- Do -----
e) Status : Individual..
f) Tax Payer Identification Number (e-TIN) : 117526397490/Circle-301.
g) Business Identification Number (BIN) : -----

This is to Certify that Md. Khandakar Safarou Zaman, Prop: Home Sense Solution is an Assessee of Taxes Circle-301, Taxes Zone-14, Dhaka. His/Her assessment has been completed under Universal Self U/S §2BB for the assessment year 2019-2020

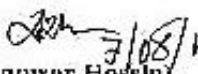

(Md. Anower Hossain)
Assistant Commissioner of Taxes
Circle-301, Taxes Zone-14, Dhaka.



THANK YOU

